

Jackson, Adrian (CON)

From: evergreentech [evergreentech@xplornet.ca]
Sent: January-09-13 2:44 PM
To: Jackson, Adrian (CON)
Subject: Dangerous Goods Handling & Transportation Act Application
Attachments: CCF09012013_0000.pdf

In response to your letter dated December 10/12

The used oil will be stored in an Enviro Tank manufactured by Advanced Ag & Industrial Ltd. Under Writers Laboratory of Canada with a holding capacity of 4756 litres. The used oil collected would be picked up by Notre Dame Oil Recycling of Notre Dame Manitoba. Notre Dame also picks up used oil jugs, oil filters and antifreeze. We can handle all these products. The rate payers who bring oil are not allowed to put their oil in the Oil Holding Tank. Our trained personal empty containers into the oil tank. We would keep a log book of oil quantity received, License plate numbers and where it came from.

When batteries are brought to Evergreen Environmental Technologies, the employees take the batteries and placed on a pallet in a sea-can. When enough are collected for a load they are shipped to Winnipeg for proper recycling. The Chemical Jugs are stored in a self contained and fenced compound. They are removed by Miller Environment for Clean Farms.

The hours of Operations for Evergreen Environmental Technologies is:

Monday to Friday 8:00 am to 4:00 pm and Saturday 8:00 am to 3:00.

Attached is a map of Battery Sea-Can and Used Oil Tank location at Evergreen Environmental Technologies.

Contact Duncan Shorrock at 204-868-6104 if you require more information.

NEEPAWA AREA REGIONAL INTEGRATED WASTE DISPOSAL FACILITY (RIWDF) EVERGREEN ENV. TEC.

15

- SCOPE OF WORK FOR HOLDING AREA THIS PER FACILITIES SPECIFIED
- CAST IN PLACE AS SPECIFIED
- FIELD WORK PER SPECIFIED
- FINISH WORK PER AS SPECIFIED
- MECHANICAL FOR MECHANICAL 02-REG. 01-01
- ELECTRICAL FOR ELECTRICAL 02-REG. 01-01
- ALTERNATE BIDDING CONTRACT HOLDING AREA
- FOR MECHANICAL 02-REG. 01-01
- FOR ELECTRICAL 02-REG. 01-01
- SCOPE OF WORK FOR
- HAZARDOUS WASTE
- SORTING LINE FOR
- HOPPERS

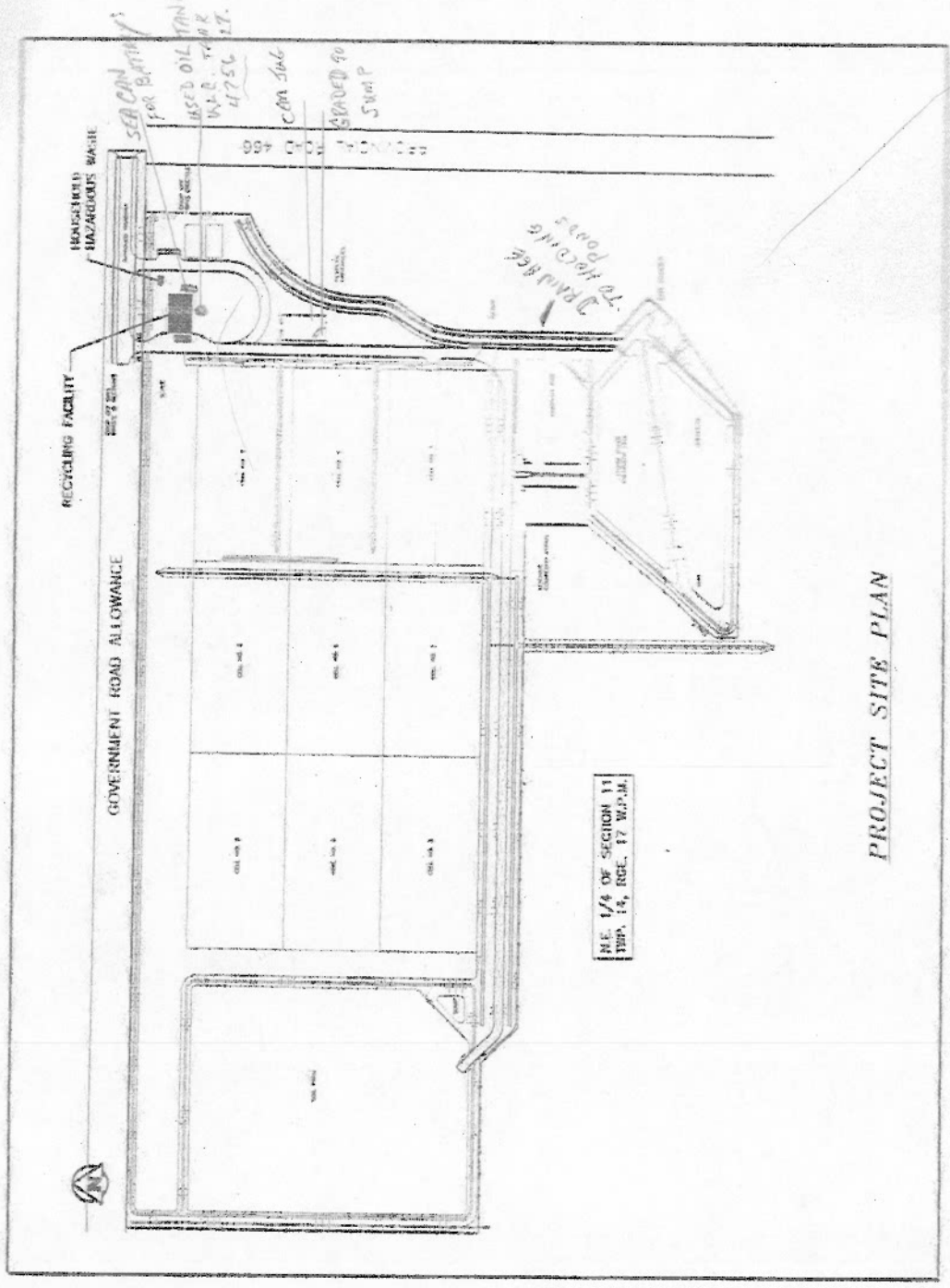

PLANS
HAZARDOUS WASTE AREA

ACFE

ENGINEERING
ME SYSTEM
SUMP PUMP

PRESSURE WASHER

1 OF 2
2 OF 2

AND SCHEDULES
IN

PLAN